



RJ45 female connector UTP Cat 6 for data cables

RJ45 UTP Cat 6 female connector, reusable and easy to connect. Assembly using a specific tool is recommended to guarantee a perfect finish.

Supplied in 15-unit professional plastic box.

Ref.	209907
Logical ref.	CAT6B-US
EAN13	8424450282465

Other features

Colour	Black
Supply method	Plastic box (15 units)
Connection type	Female

Packaging info

Plastic box	15 pcs.
--------------------	---------

Physical data

Net weight	6.00 g
Gross weight	9.00 g
Width	22.00 mm
Height	30.00 mm
Depth	16.00 mm
Main product weight	6.00 g

Highlights

- Self-crimpable connector, although the use of a termination and cutting tool is recommended to optimize connections (ref.209811)
- Reusable: can be removed and reinstalled without deteriorating or losing functionality
- Multiple-connection guaranteed without losses
- Compatible with Cat 6 or below

- Front (180°) or angled (90°) cable input
- Connection table (A or B) on the connector
- 50 microns gold-plated pins

Discover

What is the RJ45?

The RJ45 is a connector commonly used in structured cable networks. With up to 8 connection pins, it is adequate both for data networks (8 pairs), as well as telephone networks (2 pairs). It is usually used in networks compliant with standards TIA/EIA-568-B.

Compatibility of RJ45 connectors with Televes data cables:

Reference	219602	219701	219901	219910	212201	2123	212302	212305	212310	212101	219302	219312	219313	219322
Female connectors	209901/209907	OK	OK	OK	OK	OK	OK	OK	OK	X	X	X	X	X
	209905	OK	OK	OK	OK	OK	OK	OK	OK	X	X	X	X	X
	209921/209925	OK	OK	OK	OK	OK	OK	OK	OK	X	X	OK	OK	X
	209926	OK	OK	OK	OK	OK	OK	OK	OK	X	X	OK	OK	X
	209903	OK*	OK*	OK	OK*	OK*	OK*	OK*	OK*	OK	X	X	X	X
	209923	OK*	OK*	OK	OK*	OK*	OK*	OK*	OK*	OK	OK	OK*	OK*	OK
	209929/209501	OK*	OK*	OK	OK*	OK*	OK*	OK*	OK*	OK	OK	OK*	OK*	OK
Male connectors	209902	OK	OK	OK	OK	OK	OK	OK	OK	X	X	X	X	X
	209961/209962	OK	OK	OK	OK	OK	OK	OK	OK	X	X	X	X	X
	209904	OK*	OK*	OK	OK*	OK*	OK*	OK*	OK*	OK	X	X	X	X
	209906	OK	OK	OK	OK	OK	OK	OK	OK	X	X	X	X	X
	209965/209966	OK	OK	OK	OK	OK	OK	OK	OK	X	X	X	X	X
	209922	OK*	OK*	OK	OK*	OK*	OK*	OK*	OK*	X	X	OK	OK	X
	209924	OK*	OK*	OK	OK*	OK*	OK*	OK*	OK*	OK*	OK	OK*	OK*	OK

OK Compatible

OK* Compatible, but there are better choices

X Incompatible

** Mechanical compatibility

Mounting details

Assembly with tool

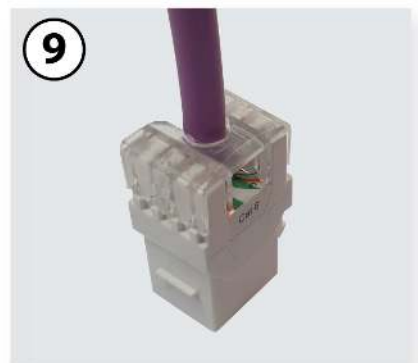
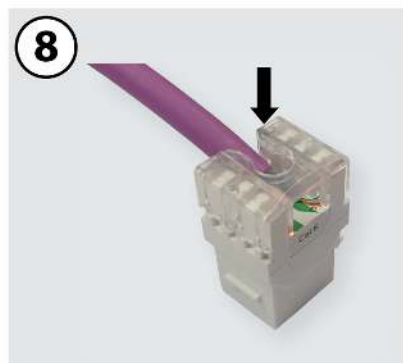
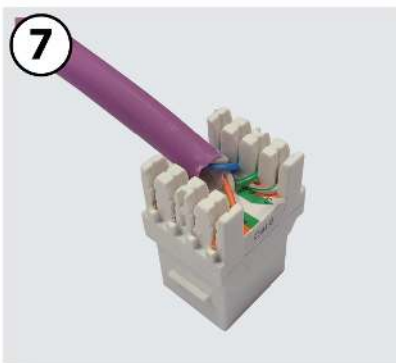
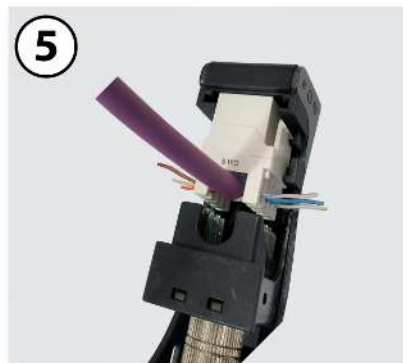
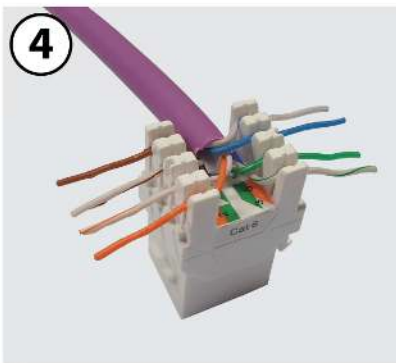
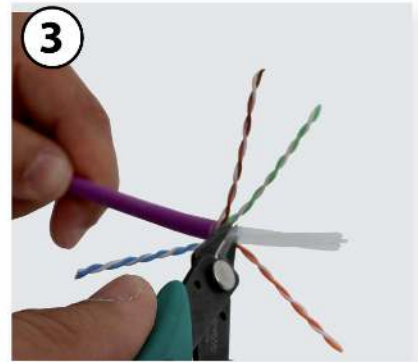
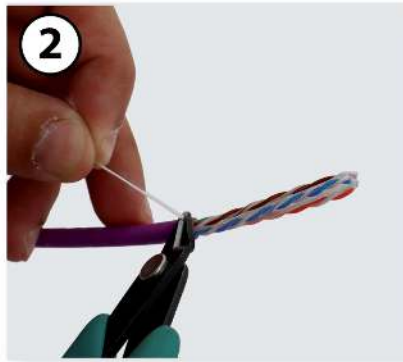
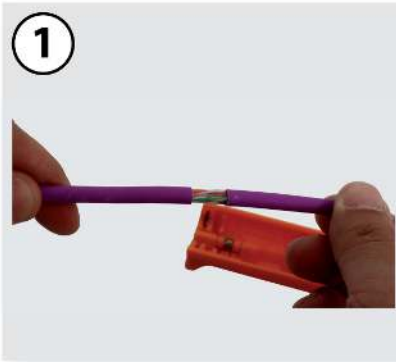

Assembly without tool

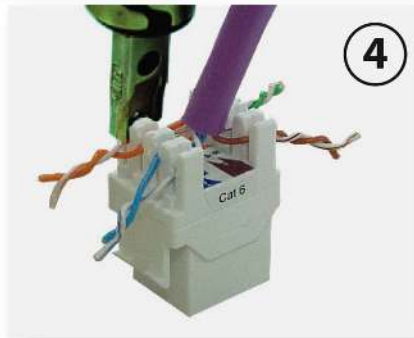
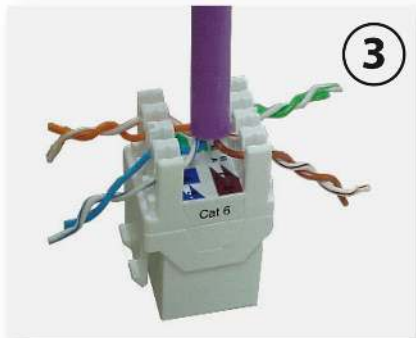
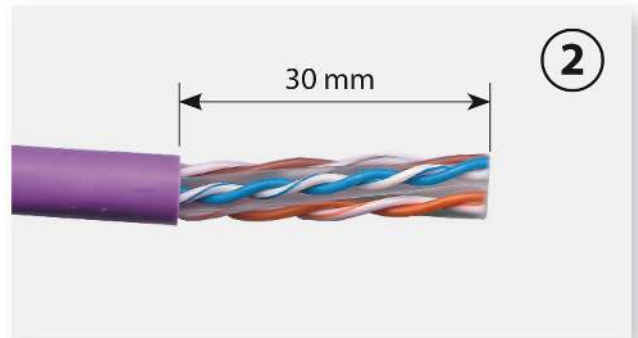

Technical specifications : Ref. 209907

Data connector model		Female
Data connector type		RJ45
Categorie		Cat 6
Voltage max.	Vac	150
Max. current	A	1.5
Contact resistance	mΩ	20
Insulation resistance	MΩ	500
Dielectric strength (60Hz/1min)	Vac	1000
Conductor type AWG		26 ... 23
Special tool required		Recommended
Durability (connection cycles)		1500
Reusable		Yes
Cable output		90°-180°